

**NOTES**  
 -ALL STORMWATER PIPES ARE RCP CLASS '3' U.N.O  
 -ALL ROOFWATER PIPES ARE Ø150 PVC CLASS 'SN8' U.N.O

**Works As Constructed**  
 It is certified that the locations, Levels and dimensions of the infrastructure shown herein are a true representation of the constructed works and that the As-Constructed survey was performed to the prescribed accuracy standards.

Authorised Delegate... *C. Walters*  
 Date... **01/07/2024**  
 LandPartners Pty Ltd (ACN 118 146 008) Surveyor No. S4118

**Works As Constructed**  
 It is certified that works herein have been constructed to Local Government standards, relevant approved specifications and the operational works approval. The As-Constructed Drawings for these works constitutes a true and correct record of the works constructed and complies with the design intent.

Signature.....RPEQ No.....  
 Date of Practical Completion.....  
 Engineering Consultant.....

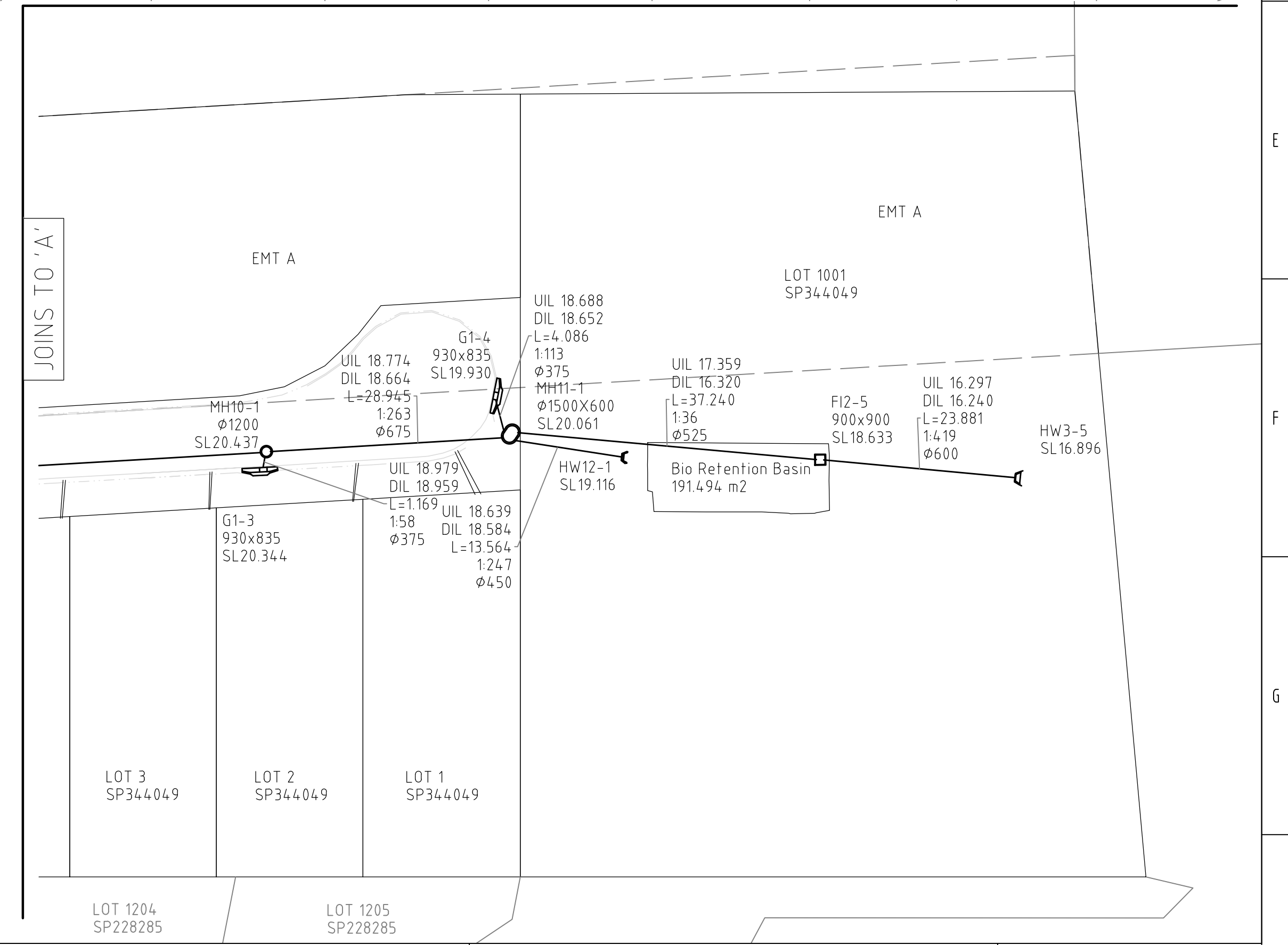

REV.	REVISION DESCRIPTION	DESIGN FILE No.	DESIGNED	DATE
1	INITIAL ISSUE	SURVEY FILE No.	DRAWN	MJK
		FIELD BOOK	CHECKED	CGW
		LOG BOOK	CHECKED	CGW
		LEVEL DATUM	DATE	28/06/2024
		DATUM		

100 Box 1350  
 MIMB GCLD 4504  
 (07) 3842 1000  
 (07) 3842 1001  
 info@landpartners.com.au  
 www.landpartners.com.au

MORETON BAY REGIONAL COUNCIL  
 CABOOLTURE DISTRICT OFFICE  
 2 HASKING STREET CABOOLTURE QLD 4510  
 PO BOX 159 CABOOLTURE QLD 4510  
 Telephone: (07) 5433 0100  
 Fax: (07) 5433 4000

SCALE 1:500  
 ORIGINAL SIZE A1

393 CABOOLTURE RIVER ROAD  
 AS-CONSTRUCTED STORMWATER  
 UPPER CABOOLTURE

SUBDIVISION REFERENCE  
 DA/2023/2553  
 PAGE NO. 1 OF 1  
 LPL PLAN NUMBER  
 BRSS8203-000-74-2