

LEGEND

- SEWER END CAP
- 600 PE SmartStream PooPit (MS)
- 1050 CONCRETE SEWER MAINTENANCE HOLE (MH)

- NOTES
- ALL SEWER RETICULATION PIPES ARE 150 uPVC S8 U.N.O.
  - ALL SEWER HOUSE CONNECTION PIPES ARE 100 uPVC S10 U.N.O.
  - ALL SEWER HOUSE CONNECTIONS DEPTHS ARE AS DESIGN.

**ENGINEER'S CERTIFICATION**

I, \_\_\_\_\_, hereby certify that:

- The information contained in this drawing / document is in compliance with approved drawings and design.
- The new water and sewerage works defined by this drawing have been designed and constructed in accordance with the SEQ Code.
- This represents an accurate record of as-constructed works.
- I accept responsibility for the information contained in this drawing / document.

RP&Q (signature) RP&Q No. \_\_\_\_\_ Date: \_\_\_\_\_

**REGISTERED SURVEYOR'S CERTIFICATION**

I, LandPartners Pty Ltd, hereby certify that the vertical and horizontal locations and dimensions shown on this plan are a true and correct record and were located by survey.

*R. G. Andrew* Authorised Delegate  
 Registered Surveyor (sig) Reg Surveyor No. S4118 Date: 11/06/2024

**COORDINATE DATUM NOTE:**  
 HORIZONTAL COORDINATES(E,N) SUPPLIED ARE MAPPING GRID OF AUSTRALIA(MGA), ZONE 56 BASED ON THE UNIVERSAL TRANSVERSE MERCATOR PROJECTION AND THE GEOCENTRIC DATUM OF AUSTRALIA 2020.

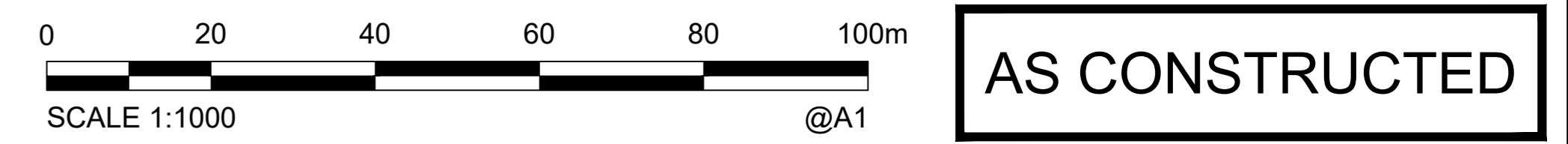
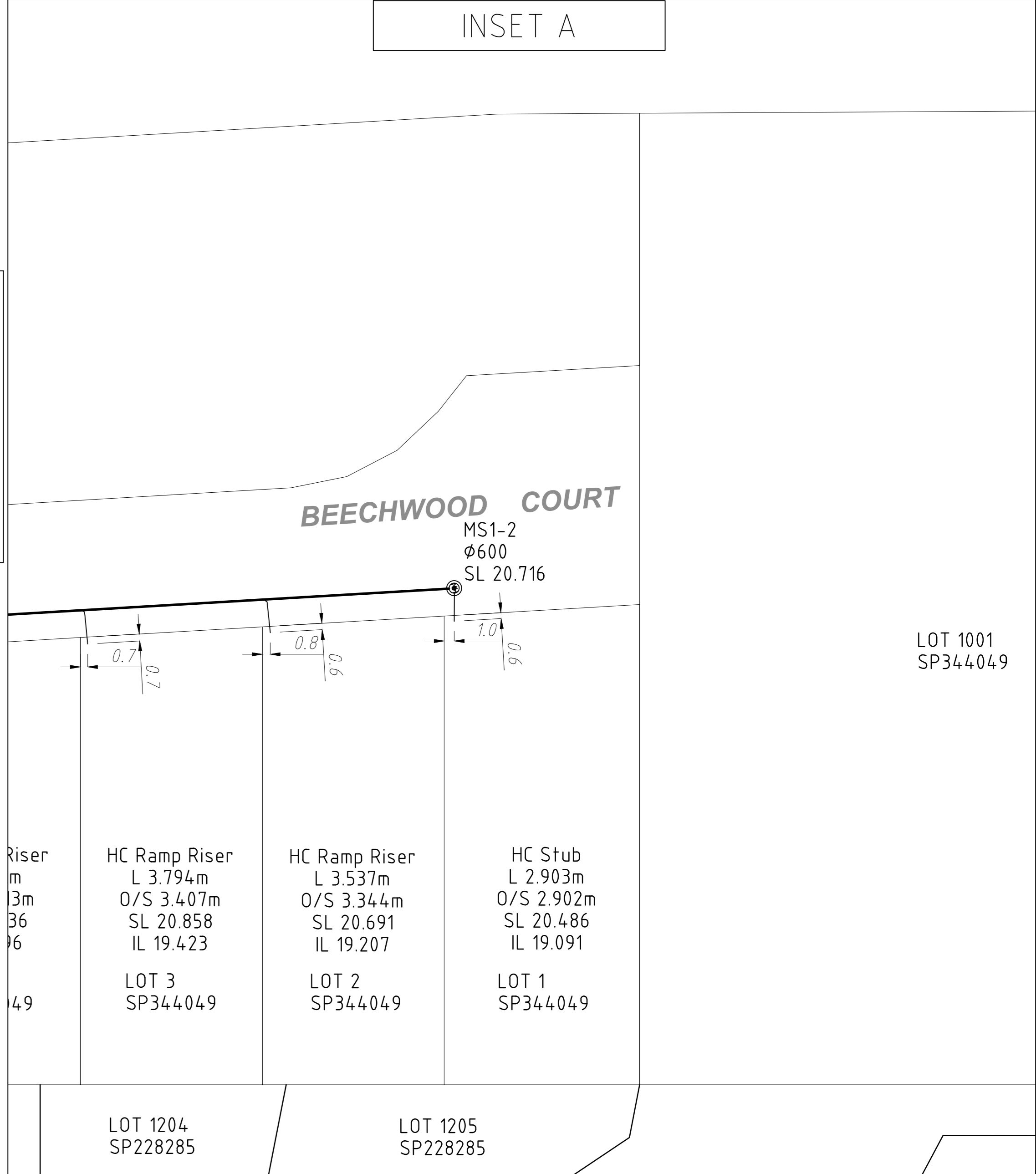

**AS CONSTRUCTED**

A1	2	11-06-2024	LABEL AMENDMENTS AND ADDED ASCON SURFACE DEPTHS	MJK	RA	RA	CHECKED	RA	11-06-2024
	1	31-05-2024	INITIAL ISSUE	MJK	RA	RA	PASSED	RA	11-06-2024
	INDEX		DATE	REVISIONS	DRAWN	CHECKED	PASSED	INITIALS	DATE

Brisbane Office  
 Level 1  
 16 Little Crab Street  
 Milton QLD 4064

PO Box 1399  
 Milton QLD 4064

P: (07) 3842 1000  
 F: (07) 3842 1001  
 E: info@landpartners.com.au  
 W: www.landpartners.com.au



**Unitywater**

202302328350  
 393 CABOOLTURE RIVER ROAD  
 AS CONSTRUCTED SEWER  
 UPPER CABOOLTURE

SHEET 1 OF 1 SHEETS	SCALE 1:1000
REVISION DATE 11-06-2024	REVISION 2
DISCIPLINE CODE C	
DRAWING NO. U-2023-5214	